



Temperature Sensitive Insulating Cap EYECAP-SIT C

Key Features

- ◆ Bare eye overheat inspection possible without additional equipment
- ◆ High quality installation
- ◆ Prevention effect of power failure and fire
- ◆ Temperature detection functions at the insulating cap ((color change to white at 70°C
- ◆ UL 94-VO incombustible material
- ◆ Smaller, can fit manufacturing facilities applications & machinery connections
- ◆ Not melting on high temperature, does not generate hazardous gas
- ◆ Dot part with irreversible color change (for E-SIT-C-50 (size and above
- ◆ Band part with reversible color change
- ◆ Inspection with naked eye increases efficiency and reduces 80% of the costs
- ◆ The world first Safety Insulated Terminal Cap made of silicon
- ◆ Bare eye inspection possible for the compressed part and pre-detection of improper installation with transparent insulation cap material

Main Applications

- ◆ Manufacturing equipment.
- ◆ Energy distribution cabinets.
- ◆ Power & Power distribution stations.
- ◆ Railways and airports.
- ◆ Hospitals.
- ◆ Construction and infrastructure networks.
- ◆ Electronic industries.
- ◆ Military and Medical large-scale systems.

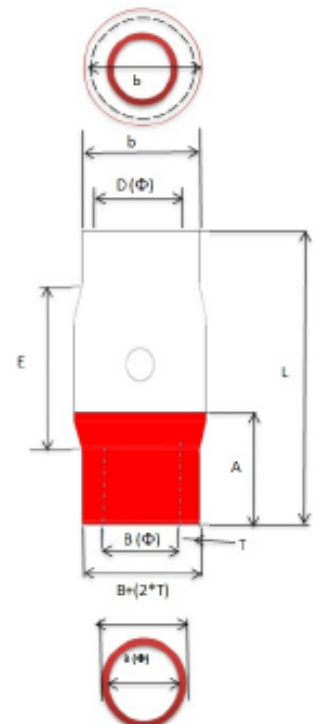
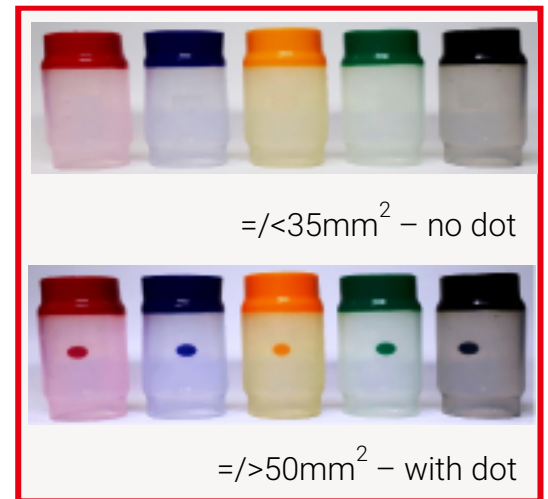

ISO 9001, CE | REACH, RoHS | KERI (ARC Resistance test) | UL | CTK (Temperature test)

Max. Operating Voltage & Temperature: 600 VRMS / 150°C

EYECAP-SIT C

Product List, Parameters & Specifications

No	Tamuz p/n:	Product dimensions (mm) (Tolerances: T ± 10% , Others ± 15%)							Wire size (AWG)	Wire size (mm2)	Color
		B	b	D	E	L	A	T			
1	E-SIT-C-25R	9	14.4	9	17.15	25.5	9	1.2	6	13-16	Red
2	E-SIT-C-25B	9	14.4	9	17.15	25.5	9	1.2	6	13-16	Blue
3	E-SIT-C-25Y	9	14.4	9	17.15	25.5	9	1.2	6	13-16	Yellow
4	E-SIT-C-25G	9	14.4	9	17.15	25.5	9	1.2	6	13-16	Green
5	E-SIT-C-25BK	9	14.4	9	17.15	25.5	9	1.2	6	13-16	Black
6	E-SIT-C-35R	11.4	16.1	10.7	18.61	28	9.5	1.2	4	20-25	Red
7	E-SIT-C-35B	11.4	16.1	10.7	18.61	28	9.5	1.2	4	20-25	Blue
8	E-SIT-C-35Y	11.4	16.1	10.7	18.61	28	9.5	1.2	4	20-25	Yellow
9	E-SIT-C-35G	11.4	16.1	10.7	18.61	28	9.5	1.2	4	20-25	Green
10	E-SIT-C-35BK	11.4	16.1	10.7	18.61	28	9.5	1.2	4	20-25	Black
11	E-SIT-C-50R	12.6	18.1	12.1	20.25	34	12.5	1.5	2~1	30-45	Red
12	E-SIT-C-50B	12.6	18.1	12.1	20.25	34	12.5	1.5	2~1	30-45	Blue
13	E-SIT-C-50Y	12.6	18.1	12.1	20.25	34	12.5	1.5	2~1	30-45	Yellow
14	E-SIT-C-50G	12.6	18.1	12.1	20.25	34	12.5	1.5	2~1	30-45	Green
15	E-SIT-C-50BK	12.6	18.1	12.1	20.25	34	12.5	1.5	2~1	30-45	Black
16	E-SIT-C-70R	15.36	21.3	15.06	25.14	39	14	1.5	1/0	50-60	Red
17	E-SIT-C-70B	15.36	21.3	15.06	25.14	39	14	1.5	1/0	50-60	Blue
18	E-SIT-C-70Y	15.36	21.3	15.06	25.14	39	14	1.5	1/0	50-60	Yellow
19	E-SIT-C-70G	15.36	21.3	15.06	25.14	39	14	1.5	1/0	50-60	Green
20	E-SIT-C-70BK	15.36	21.3	15.06	25.14	39	14	1.5	1/0	50-60	Black
21	E-SIT-C-95R	16.96	23.71	17.5	26.95	44.27	17.27	1.6	2/0	60-80	Red
22	E-SIT-C-95B	16.96	23.71	17.5	26.95	44.27	17.27	1.6	2/0	60-80	Blue
23	E-SIT-C-95Y	16.96	23.71	17.5	26.95	44.27	17.27	1.6	2/0	60-80	Yellow
24	E-SIT-C-95G	16.96	23.71	17.5	26.95	44.27	17.27	1.6	2/0	60-80	Green
25	E-SIT-C-95BK	16.96	23.71	17.5	26.95	44.27	17.27	1.6	2/0	60-80	Black
No	Tamuz p/n:	Product dimensions (mm) (Tolerances: T ± 10% , Others ± 15%)							Wire size (AWG)	Wire size (mm2)	Color
		B	b	D	E	L	A	T			
26	E-SIT-C-120R	19.6	26.21	20	29.22	48.5	18.7	1.6	3/0	80-90	Red
27	E-SIT-C-120B	19.6	26.21	20	29.22	48.5	18.7	1.6	3/0	80-90	Blue
28	E-SIT-C-120Y	19.6	26.21	20	29.22	48.5	18.7	1.6	3/0	80-90	Yellow
29	E-SIT-C-120G	19.6	26.21	20	29.22	48.5	18.7	1.6	3/0	80-90	Green
30	E-SIT-C-120BK	19.6	26.21	20	29.22	48.5	18.7	1.6	3/0	80-90	Black
31	E-SIT-C-150R	21.98	28.39	21.9	33.16	55	21	1.7	4/0~250Kcmil	100-135	Red
32	E-SIT-C-150B	21.98	28.39	21.9	33.16	55	21	1.7	4/0~250Kcmil	100-135	Blue
33	E-SIT-C-150Y	21.98	28.39	21.9	33.16	55	21	1.7	4/0~250Kcmil	100-135	Yellow
34	E-SIT-C-150G	21.98	28.39	21.9	33.16	55	21	1.7	4/0~250Kcmil	100-135	Green
35	E-SIT-C-150BK	21.98	28.39	21.9	33.16	55	21	1.7	4/0~250Kcmil	100-135	Black
36	E-SIT-C-185R	24.6	31.7	24.6	33.31	56.9	21.5	1.7	300Kcmil	145-160	Red
37	E-SIT-C-185B	24.6	31.7	24.6	33.31	56.9	21.5	1.7	300Kcmil	145-160	Blue
38	E-SIT-C-185Y	24.6	31.7	24.6	33.31	56.9	21.5	1.7	300Kcmil	145-160	Yellow
39	E-SIT-C-185G	24.6	31.7	24.6	33.31	56.9	21.5	1.7	300Kcmil	145-160	Green
40	E-SIT-C-185BK	24.6	31.7	24.6	33.31	56.9	21.5	1.7	300Kcmil	145-160	Black
41	E-SIT-C-240R	29.2	36.64	29.74	36.61	64	24.2	1.8	350~400Kcmil	175-210	Red
42	E-SIT-C-240B	29.2	36.64	29.74	36.61	64	24.2	1.8	350~400Kcmil	175-210	Blue
43	E-SIT-C-240Y	29.2	36.64	29.74	36.61	64	24.2	1.8	350~400Kcmil	175-210	Yellow
44	E-SIT-C-240G	29.2	36.64	29.74	36.61	64	24.2	1.8	350~400Kcmil	175-210	Green
45	E-SIT-C-240BK	29.2	36.64	29.74	36.61	64	24.2	1.8	350~400Kcmil	175-210	Black
46	E-SIT-C-300R	30.82	39	30.82	40.49	72.96	27.66	1.9	450~500Kcmil	225-260	Red
47	E-SIT-C-300B	30.82	39	30.82	40.49	72.96	27.66	1.9	450~500Kcmil	225-260	Blue
48	E-SIT-C-300Y	30.82	39	30.82	40.49	72.96	27.66	1.9	450~500Kcmil	225-260	Yellow
49	E-SIT-C-300G	30.82	39	30.82	40.49	72.96	27.66	1.9	450~500Kcmil	225-260	Green
50	E-SIT-C-300BK	30.82	39	30.82	40.49	72.96	27.66	1.9	450~500Kcmil	225-260	Black