



## Temperature Sensitive Insulating Cap EYECAP-SIT(B)

### Key Features

- ◆ Bare eye overheat inspection possible without additional equipment
- ◆ High quality installation
- ◆ Prevention effect of power failure and fire
- ◆ Temperature detection functions at the insulating cap (color change to white at 70°C)
- ◆ UL 94-VO incombustible material
- ◆ Smaller, can fit manufacturing facilities applications & machinery connections
- ◆ Not melting on high temperature, does not generate hazardous gas
- ◆ Dot part with irreversible color change (for E-SIT-B-50 size and above)
- ◆ Band part with reversible color change
- ◆ Inspection with naked eye increases efficiency and reduces 80% of the costs
- ◆ The world first Safety Insulated Terminal Cap made of silicon
- ◆ Bare eye inspection possible for the compressed part and pre-detection of improper installation with transparent insulation cap material



### Main Applications

- ◆ Manufacturing equipment.
- ◆ Energy distribution cabinets.
- ◆ Power & Power distribution stations.
- ◆ Railways and airports.
- ◆ Hospitals.
- ◆ Construction and infrastructure networks.
- ◆ Electronic industries.
- ◆ Military and Medical large-scale systems.

ISO 9001, CE | REACH, RoHS | KERI (ARC Resistance test) | UL | CTK (Temperature test)

Max. Operating Voltage & Temperature: 600 VRMS / 150°C

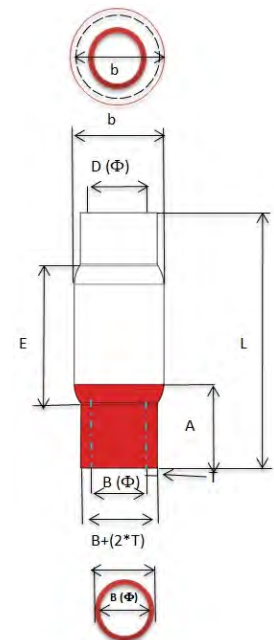

# Temperature Sensitive Insulating Cap EYECAP-SIT(A)

## EYECAP-SIT(A)

### Product List, Parameters & Specifications

No	Tamuz p/n:	Product dimensions (mm) (Tolerances: T $\pm$ 10% , Others $\pm$ 15%)							Wire size (AWG)	Wire size (mm <sup>2</sup> )	Color
		B	b	D	E	L	A	T			
1	E-SIT-B-25R	8.5	13.9	9	14	25.5	9	1	6	13-16	Red
2	E-SIT-B-25B	8.5	13.9	9	14	25.5	9	1	6	13-16	Blue
3	E-SIT-B-25Y	8.5	13.9	9	14	25.5	9	1	6	13-16	Yellow
4	E-SIT-B-25G	8.5	13.9	9	14	25.5	9	1	6	13-16	Green
5	E-SIT-B-25BK	8.5	13.9	9	14	25.5	9	1	6	13-16	Black
6	E-SIT-B-35R	10.4	15.8	11.4	17.3	28	9.4	1.1	4	20-25	Red
7	E-SIT-B-35B	10.4	15.8	11.4	17.3	28	9.4	1.1	4	20-25	Blue
8	E-SIT-B-35Y	10.4	15.8	11.4	17.3	28	9.4	1.1	4	20-25	Yellow
9	E-SIT-B-35G	10.4	15.8	11.4	17.3	28	9.4	1.1	4	20-25	Green
10	E-SIT-B-35BK	10.4	15.8	11.4	17.3	28	9.4	1.1	4	20-25	Black
11	E-SIT-B-50R	12.2	17.6	13.2	34.3	43	9.4	1.2	2~1	30-45	Red
12	E-SIT-B-50B	12.2	17.6	13.2	34.3	43	9.4	1.2	2~1	30-45	Blue
13	E-SIT-B-50Y	12.2	17.6	13.2	34.3	43	9.4	1.2	2~1	30-45	Yellow
14	E-SIT-B-50G	12.2	17.6	13.2	34.3	43	9.4	1.2	2~1	30-45	Green
15	E-SIT-B-50BK	12.2	17.6	13.2	34.3	43	9.4	1.2	2~1	30-45	Black
16	E-SIT-B-70R	14.6	20.6	15.6	36.7	49	11.4	1.5	1/0	50-60	Red
17	E-SIT-B-70B	14.6	20.6	15.6	36.7	49	11.4	1.5	1/0	50-60	Blue
18	E-SIT-B-70Y	14.6	20.6	15.6	36.7	49	11.4	1.5	1/0	50-60	Yellow
19	E-SIT-B-70G	14.6	20.6	15.6	36.7	49	11.4	1.5	1/0	50-60	Green
20	E-SIT-B-70BK	14.6	20.6	15.6	36.7	49	11.4	1.5	1/0	50-60	Black
21	E-SIT-B-95R	17.06	23.27	17.06	36.4	57.94	15.46	1.6	2/0	60-80	Red
22	E-SIT-B-95B	17.06	23.27	17.06	36.4	57.94	15.46	1.6	2/0	60-80	Blue
23	E-SIT-B-95Y	17.06	23.27	17.06	36.4	57.94	15.46	1.6	2/0	60-80	Yellow
24	E-SIT-B-95G	17.06	23.27	17.06	36.4	57.94	15.46	1.6	2/0	60-80	Green
25	E-SIT-B-95BK	17.06	23.27	17.06	36.4	57.94	15.46	1.6	2/0	60-80	Black
26	E-SIT-B-120R	19.5	25.71	19.5	40.1	61.94	16.91	1.6	3/0	80-90	Red
27	E-SIT-B-120B	19.5	25.71	19.5	40.1	61.94	16.91	1.6	3/0	80-90	Blue
28	E-SIT-B-120Y	19.5	25.71	19.5	40.1	61.94	16.91	1.6	3/0	80-90	Yellow
29	E-SIT-B-120G	19.5	25.71	19.5	40.1	61.94	16.91	1.6	3/0	80-90	Green
30	E-SIT-B-120BK	19.5	25.71	19.5	40.1	61.94	16.91	1.6	3/0	80-90	Black

No	Tamuz p/n:	Product dimensions (mm) (Tolerances: T ± 10% , Others ± 15%)							Wire size (AWG)	Wire size (mm2)	Color
		B	b	D	L	A	T				
31	E-SIT-B-150R	21.72	28.21	21.8	40.1	67.5	22	1.7	4/0~250Kcmil	100-135	Red
32	E-SIT-B-150B	21.72	28.21	21.8	40.1	67.5	22	1.7	4/0~250Kcmil	100-135	Blue
33	E-SIT-B-150Y	21.72	28.21	21.8	40.1	67.5	22	1.7	4/0~250Kcmil	100-135	Yellow
34	E-SIT-B-150G	21.72	28.21	21.8	40.1	67.5	22	1.7	4/0~250Kcmil	100-135	Green
35	E-SIT-B-150BK	21.72	28.21	21.8	40.1	67.5	22	1.7	4/0~250Kcmil	100-135	Black
36	E-SIT-B-185R	24.3	31.7	24.3	48.6	76.2	23.59	1.7	300Kcmil	145-160	Red
37	E-SIT-B-185B	24.3	31.7	24.3	48.6	76.2	23.59	1.7	300Kcmil	145-160	Blue
38	E-SIT-B-185Y	24.3	31.7	24.3	48.6	76.2	23.59	1.7	300Kcmil	145-160	Yellow
39	E-SIT-B-185G	24.3	31.7	24.3	48.6	76.2	23.59	1.7	300Kcmil	145-160	Green
40	E-SIT-B-185BK	24.3	31.7	24.3	48.6	76.2	23.59	1.7	300Kcmil	145-160	Black
41	E-SIT-B-240R	28.9	36.1	28.9	54.5	85.5	25.59	1.8	350~400Kcmil	175-210	Red
42	E-SIT-B-240B	28.9	36.1	28.9	54.5	85.5	25.59	1.8	350~400Kcmil	175-210	Blue
43	E-SIT-B-240Y	28.9	36.1	28.9	54.5	85.5	25.59	1.8	350~400Kcmil	175-210	Yellow
44	E-SIT-B-240G	28.9	36.1	28.9	54.5	85.5	25.59	1.8	350~400Kcmil	175-210	Green
45	E-SIT-B-240BK	28.9	36.1	28.9	54.5	85.5	25.59	1.8	350~400Kcmil	175-210	Black
46	E-SIT-B-300R	30.82	39.2	30.82	66.5	95.28	27.46	1.9	450~500Kcmil	225-260	Red
47	E-SIT-B-300B	30.82	39.2	30.82	66.5	95.28	27.46	1.9	450~500Kcmil	225-260	Blue
48	E-SIT-B-300Y	30.82	39.2	30.82	66.5	95.28	27.46	1.9	450~500Kcmil	225-260	Yellow
49	E-SIT-B-300G	30.82	39.2	30.82	66.5	95.28	27.46	1.9	450~500Kcmil	225-260	Green
50	E-SIT-B-300BK	30.82	39.2	30.82	66.5	95.28	27.46	1.9	450~500Kcmil	225-260	Black
51	E-SIT-B-400R	34.4	42.8	34.4	72.7	101	30.12	2.1	550~650Kcmil	270-330	Red
52	E-SIT-B-400B	34.4	42.8	34.4	72.7	101	30.12	2.1	550~650Kcmil	270-330	Blue
53	E-SIT-B-400Y	34.4	42.8	34.4	72.7	101	30.12	2.1	550~650Kcmil	270-330	Yellow
54	E-SIT-B-400G	34.4	42.8	34.4	72.7	101	30.12	2.1	550~650Kcmil	270-330	Green
55	E-SIT-B-400BK	34.4	42.8	34.4	72.7	101	30.12	2.1	550~650Kcmil	270-330	Black
56	E-SIT-B-500R	38.12	49.6	39.5	79.1	107	31.67	2.4	700~800Kcmil	350-410	Red
57	E-SIT-B-500B	38.12	49.6	39.5	79.1	107	31.67	2.4	700~800Kcmil	350-410	Blue
58	E-SIT-B-500Y	38.12	49.6	39.5	79.1	107	31.67	2.4	700~800Kcmil	350-410	Yellow
59	E-SIT-B-500G	38.12	49.6	39.5	79.1	107	31.67	2.4	700~800Kcmil	350-410	Green
60	E-SIT-B-500BK	38.12	49.6	39.5	79.1	107	31.67	2.4	700~800Kcmil	350-410	Black

Remarks:

1. Dot part with irreversible color change: Only for E-SIT-A-50 size and above.
2. Cross reference: (EYECAP p/n: EYECAP-SIT(A)-nnnaa) = (Tamuz p/n: E-SIT-A-nnaa).
3. The wire size (AWG/mm2) is for reference only. The appropriate SIT model, will be defined by the actual outer diameter and size of the wire and the terminal in use.
4. Dimensions are shown for reference purposes only and in millimeters unless otherwise specified.
5. Product specifications are subject to change without notice.

